

Sager Corporate Park Lot 2

2054 Keene Parkway, Belvidere, Illinois 61008 - Boone County



Property Details

Latitude/Longitude: 42.2396, -88.8342

Type of space: Vacant Land

Min Size: 1.14 acres

Max Size: 1.14 acres

Last Updated: 3/2/2021

Availability

Sale Price: \$288,000.00

For Sale: Yes

Sale Terms:

Site Details

Lot Size: 49,849.26 sf

Contiguous Acres Available for Development: Yes acres

Parcel: 07-01-127-007

Total Acres: 1.14 acres

Property Description: 1-43-3 LOT 2 REPLAT LOT 2 PLAT 3 AND LOT 3 PLAT 1 SAGER CORPORATE PARK AKA SAGER CORPORATE PARK PLAT 5

Incentives

Enterprise Zone: Yes

Foreign Trade Zone: Yes

Transportation

Nearest Airport: Chicago/Rockford International Airport

Distance to Airport: 17 miles

Nearest Interstate: I90

Distance to Interstate: 1 miles

Nearest Highway: Route 20

Distance to Major Highway: 1/2 miles

Rail Access: Yes

Rail Provider: Union Pacific

Utilities

Electric Service Provider: ComEd

Natural Gas Provider: Nicor

Sewer Provider: City of Belvidere

Water Service Provider: City of Belvidere

Other

Zoning: M-2 Heavy Industrial

Contacts

Company: Growth Dimensions

Name: Pam Lopez-Fettes

Phone: 18155474252

Email: pfettes@growthdimensions.org

Website: www.growthdimensions.com

Address: 401 Whiteny Blvd

City: Belvidere

Description

1-43-3 LOT 2 REPLAT LOT 2 PLAT 3 AND LOT 3 PLAT 1 SAGER CORPORATE PARK AKA SAGER CORPORATE PARK PLAT 5

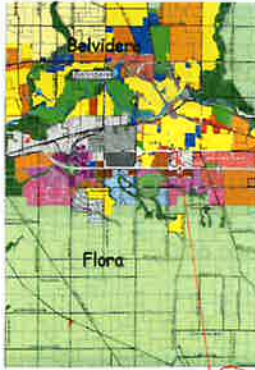

Flora County Comprehensive Plan
7a: Planned Land Use
Flora County
November 10, 1999; Amended February 5, 2008
Caleb Carter, Director, Dept. of County
Administration & Finance



Sager Corporate Park 2.png



Sager Advertising Sign.jpg

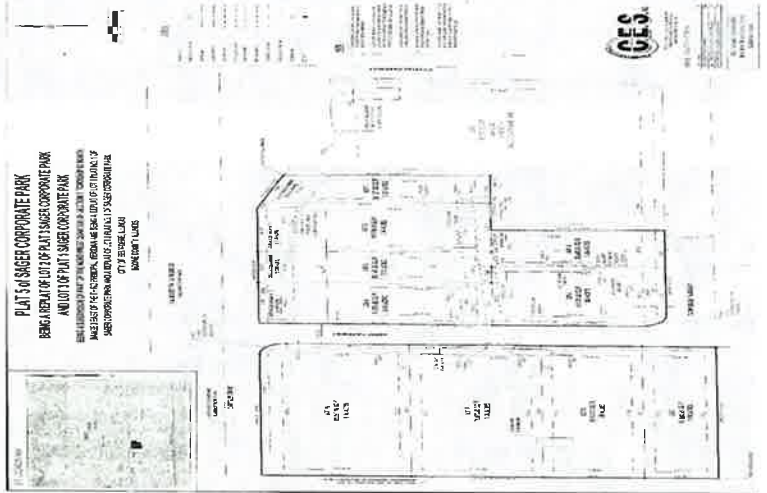

Sager Corporate Park 3.png